

GN 913.2

Grub screws

• Screw

Steel, blackened.

• Nose

- Execution **A**: steel, hardened and spherical.
- Execution **B**: steel, hardened and pointed.

Applications

Grub screws GN 913.2 with hardened spherical nose (execution A) are used in such cases where point contact is required. They are a lower cost alternative to ball point screws GN 605 (see page 591) and GN 606 (see page 593). Grub screws GN 913.2 with hardened pointed nose (execution B) offer an alternative form of finish. Furthermore they can be used as a locator for a drill.



GN 913.2-A

GN 913.2-B

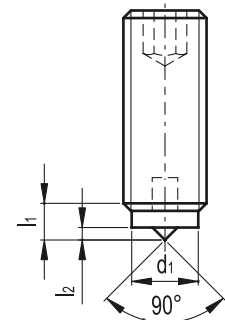
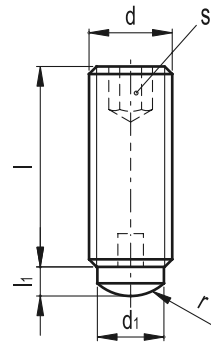

Standard Elements	Main dimensions							△△
Description	d	l	d ₁	l ₁	l ₂	r	s	g
GN 913.2-M5-8-A	M5	8	3	1	-	2.5	2.5	1
GN 913.2-M5-12-A	M5	12	3	1	-	2.5	2.5	1
GN 913.2-M5-16-A	M5	16	3	1	-	2.5	2.5	1
GN 913.2-M5-20-A	M5	20	3	1	-	2.5	2.5	2
GN 913.2-M5-8-B	M5	8	3	1	0.5	-	2.5	1
GN 913.2-M5-12-B	M5	12	3	1	0.5	-	2.5	1
GN 913.2-M5-16-B	M5	16	3	1	0.5	-	2.5	1
GN 913.2-M5-20-B	M5	20	3	1	0.5	-	2.5	2
GN 913.2-M6-12-A	M6	12	4	1.8	-	3	3	2
GN 913.2-M6-16-A	M6	16	4	1.8	-	3	3	3
GN 913.2-M6-20-A	M6	20	4	1.8	-	3	3	3
GN 913.2-M6-25-A	M6	25	4	1.8	-	3	3	4
GN 913.2-M6-12-B	M6	12	4	1.8	0.8	-	3	2
GN 913.2-M6-16-B	M6	16	4	1.8	0.8	-	3	3
GN 913.2-M6-20-B	M6	20	4	1.8	0.8	-	3	4
GN 913.2-M6-25-B	M6	25	4	1.8	0.8	-	3	4
GN 913.2-M8-12-A	M8	12	6	2.5	-	5	4	3
GN 913.2-M8-16-A	M8	16	6	2.5	-	5	4	5
GN 913.2-M8-20-A	M8	20	6	2.5	-	5	4	6
GN 913.2-M8-25-A	M8	25	6	2.5	-	5	4	7
GN 913.2-M8-32-A	M8	32	6	2.5	-	5	4	9
GN 913.2-M8-12-B	M8	12	6	2.5	1	5	4	3
GN 913.2-M8-16-B	M8	16	6	2.5	1	5	4	5
GN 913.2-M8-20-B	M8	20	6	2.5	1	5	4	6
GN 913.2-M8-25-B	M8	25	6	2.5	1	5	4	7
GN 913.2-M8-32-B	M8	32	6	2.5	1	5	4	9
GN 913.2-M10-16-A	M10	16	8	3.5	-	6	5	7
GN 913.2-M10-20-A	M10	20	8	3.5	-	6	5	9
GN 913.2-M10-25-A	M10	25	8	3.5	-	6	5	11
GN 913.2-M10-32-A	M10	32	8	3.5	-	6	5	15
GN 913.2-M10-40-A	M10	40	8	3.5	-	6	5	18
GN 913.2-M10-16-B	M10	16	8	3.5	1.5	6	5	7
GN 913.2-M10-20-B	M10	20	8	3.5	1.5	6	5	9
GN 913.2-M10-25-B	M10	25	8	3.5	1.5	6	5	11
GN 913.2-M10-32-B	M10	32	8	3.5	1.5	6	5	15
GN 913.2-M10-40-B	M10	40	8	3.5	1.5	6	5	18