

# I.680 SOFT

SOFT

ELESA Original design

## Handles



### Material

High-resilience polypropylene based (PP) technopolymer, coated with "soft-touch" thermoplastic elastomer (TPE) chemically bonded, hardness 70 Shore A. Resistant to solvents, oils, greases and other chemical agents. The coating material is certified according to FDA (U.S. Food and Drug Administration).

### Colour

Black, matte finish.

### Standard execution

Threaded blind hole.

### Features and applications

The coating, with "soft-touch" elastomer, improves the grip even in the presence of oils, greases and sweat from the hand. For this reason it is suitable for fitness machines, tools and machines for gardening and goods transport, high-precision instruments and disability aids.

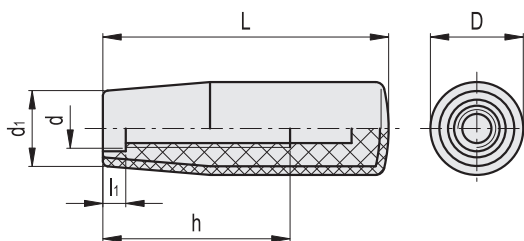

Standard Elements		Main dimensions			Mounting hole			$\Delta$
Code	Description	L	D	d <sub>1</sub>	d	h	l <sub>i</sub>	g
124861	I.680/65-M8 SOFT	65	24.5	20.5	M8	30	7	34
124862	I.680/65-M10 SOFT	65	24.5	20.5	M10	30	7	33
124864	I.680/80-M8 SOFT	80	26.5	21	M8	55	7	46
124865	I.680/80-M10 SOFT	80	26.5	21	M10	55	7	45
124866	I.680/80-M12 SOFT	80	26.5	21	M12	55	7	44
124871	I.680/90-M10 SOFT	90	28.5	22	M10	56	7	51
124872	I.680/90-M12 SOFT	90	28.5	22	M12	58	7	50

# I.167 p

## Handles



### Material

Phenolic based (PF) Duroplast body, polyamide based (PA) technopolymer flange. Resistant to solvents, oils, greases and other chemical agents.

### Colour

Black, glossy finish.

### Standard execution

Zinc-plated steel threaded stud, with chamfered flat end according to UNI 947 : ISO 4753 (see catalogue 038, page A11).

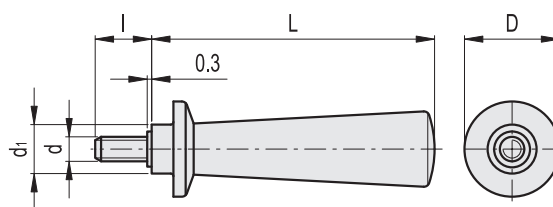

Standard Elements		Main dimensions			Threaded stud		$\Delta$
Code	Description	L	D	d <sub>1</sub>	d <sub>6g</sub>	l	g
20306	I.167/103 p-M8x16	104	35	18	M8	16	90
20311	I.167/103 p-M8x25	104	35	18	M8	25	94