

Counterbored
for cap screw
DIN 912

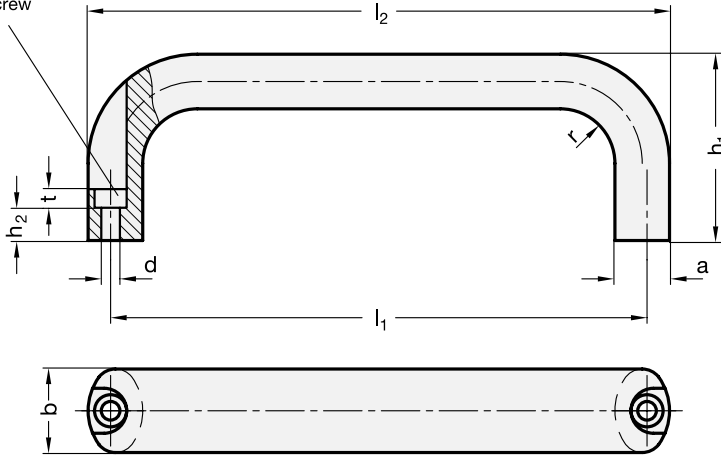

1

2

b	l ₁ ±0,25	a	d	h ₁	h ₂	l ₂	r	t
20	100	13	5,4	49	13,5	112	13	5,5
20	112	13	5,4	49	13,5	124	13	5,5
20	128	13	5,4	51	13,5	140	13	5,5
20	160	13	5,4	51	13,5	172	13	5,5
26	116	17	6,4	55	11	130	17	6
26	132	17	6,4	55	11	146	17	6
26	164	17	6,4	57	11	178	17	6
26	179	17	6,4	57	11	193	17	6
26	196	17	6,4	57	11	210	17	6

Specification

- Aluminium
 - plastic coated
 - black, RAL 9005, textured finish
 - red, RAL 3000, textured finish
 - silver, RAL 9006, textured finish
 - anodized, natural colour
 - blank
 - tumbled

- SW
- RS
- SR
- EL
- BL

• Load rating information → Page 1152

• RoHS compliant

3

Information

Cabinet „U“ handles GN 565.1 are produced from profiled aluminium extrusions. Their special features are their rigidity and ergonomical shaping.

The manufacturing process (bending) allows the production of **special lengths** in relatively small quantities.

How to order

GN 565.1-26-132-SW

- 1 b
- 2 l₁
- 3 Finish